

# Campus Maps

## CAMPUS LOCATION

The Institute has two campuses in Tralee.  
Depending on your chosen course, you will be located in either the North Campus in Dromtacker or the South Campus in Clash.



## NORTH CAMPUS (NC)

Students studying the following courses are based in North Campus:

- Business
- Humanities & Social Sciences
- Hotel, Culinary & Tourism
- Creative Media & Information Technology
- Computing
- Nursing

## SOUTH CAMPUS (SC)

Students studying the following courses are based in South Campus:

- Engineering & Construction
- Biological & Pharmaceutical Science
- Health & Leisure



PLEASE NOTE THAT OPENING AND CLOSING TIMES WILL VARY DURING THE YEAR.

## CAMPUS MAPS SOUTH CAMPUS



# NORTH CAMPUS OVERVIEW

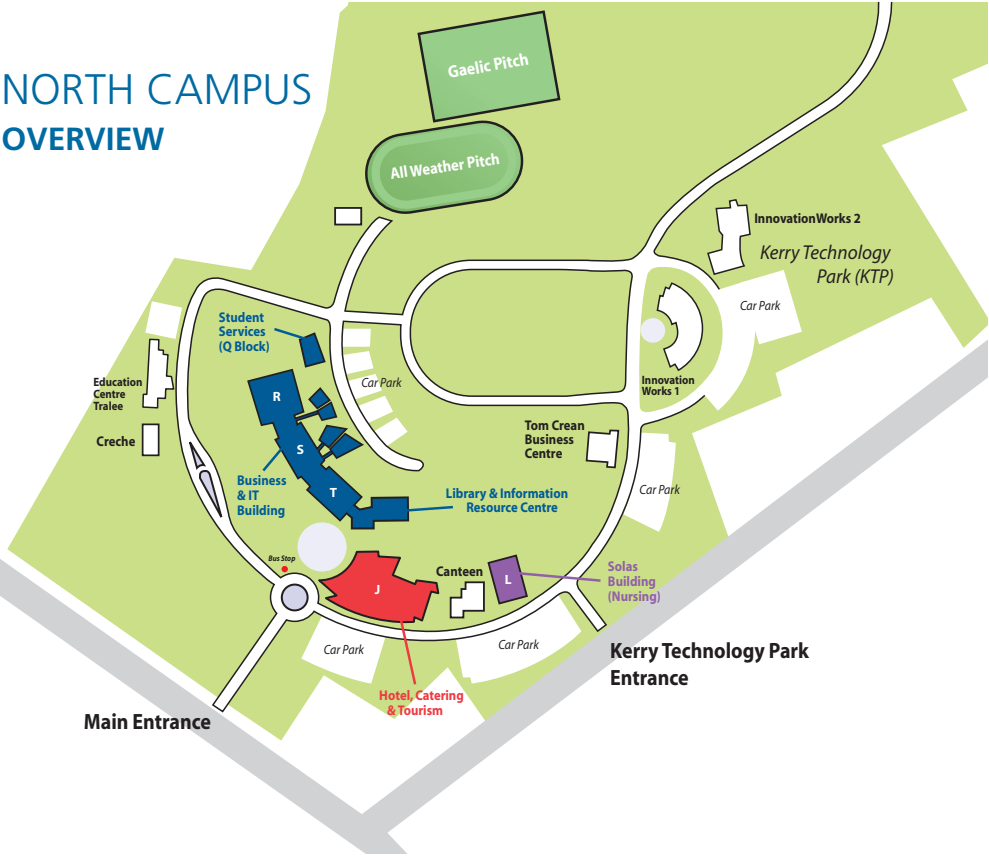

## NORTH CAMPUS (NC) Q BLOCK - Student Services Centre

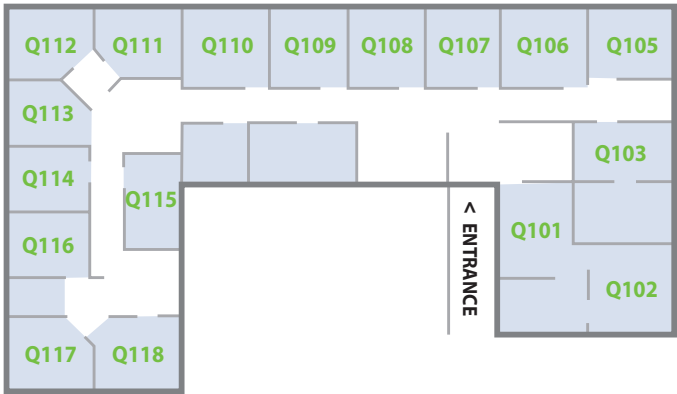

- Q109 Access Officer
- Q111 Chaplain
- Q112 Counsellor
- Q115 Dyslexia Support Officer
- Q106 Careers Officer
- Q116 Nurse/Doctor
- Q105 Pathfinders Co-ordinator
- Q108 Societies Officer
- Q103 Sports Officer
- Q101 Learning Support Tutor
- Q105 Traveller Community Liaison Officer

## CAMPUS MAPS NORTH CAMPUS

### NORTH CAMPUS (NC) BUSINESS & INFORMATION TECHNOLOGY BUILDING

